



# CADENAS TRANSPORTADORAS

## DIN 8167 – ISO / R1977

### TALADROS CENTRALES / EJES PROLONGADOS

Ref. Cadena	TALADROS CENTRADOS			
	Paso mínimo	Ø taladro central	Ø taladro lateral	Paso entre taladros
	P	O	R	M
M-20	X	9	X	X
M-28	125	9	5,5	50
M-40	160	11	6,6	63
M-56	160	11	6,6	63
M-80	200	14	9	80
M-112	200	18	9	80
M-160	250	22	11	100
M-224	250	22	11	100
M-315	315	26	14	125
M-450	315	30	18	125
M-630	400	36	22	160
M-900	500	45	22	200

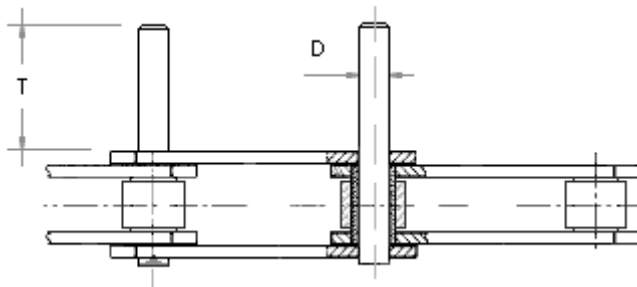
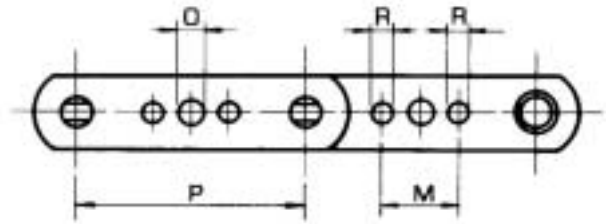

Ref. Cadena	EJES PROLONGADOS	
	Ø mm.	Saliente
	D	T
M-20	6	21
M-28	7	23
M-40	8,5	26
M-56	10	31
M-80	12	37
M-112	15	42
M-160	18	49
M-224	21	57
M-315	25	66
M-450	30	78
M-630	36	91
M-900	44	106