

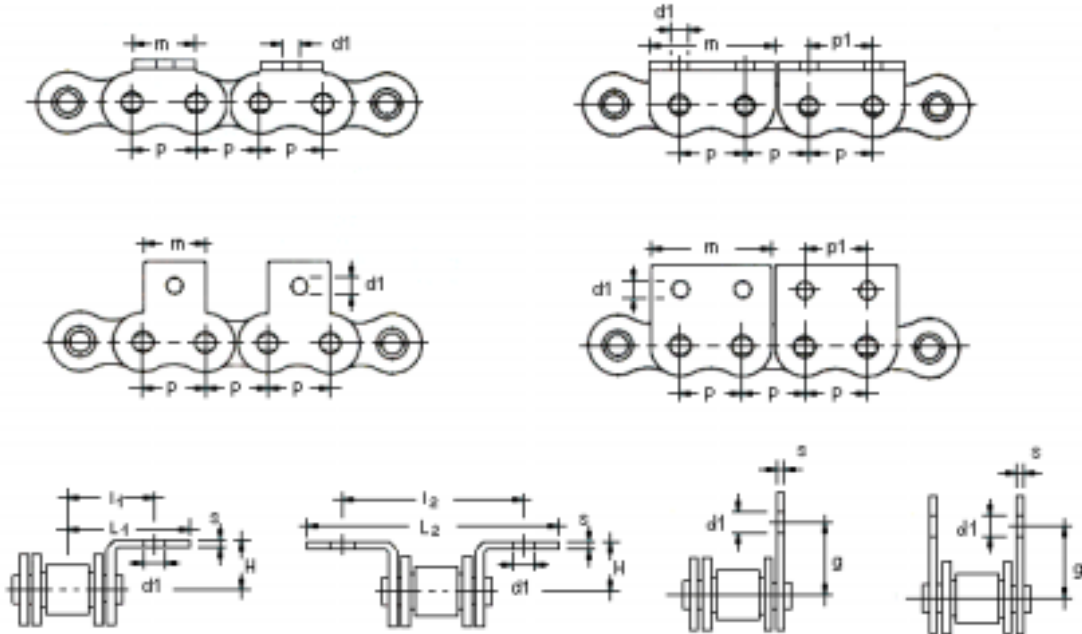

CADENAS DE TRANSMISIÓN

Serie ISO Norma Europea DIN 8187
ACCESORIOS NORMALIZADOS 08B-1 (12,7)



ACCESORIOS NORMALIZADOS DISPONIBLES PARA CADENA 08B (Paso 12,7 mm.)

Ref. Accesorio	Tipo	Nº Taladros	Ø D1	p2	m	H	l1	l2	L1	L2	g	S
08B1.41	Recta	1	4,3	--	10,2	--	--	--	--	--	12,7	1,5
08B1.42	Recta	2	4,3	12,7	24,3	--	--	--	--	--	12,7	1,5
08B1.61	90°	1	4,3	--	10,2	8,9	12,7	25,4	17,6	35,2	--	1,5
08B1.62	90°	2	4,3	12,7	24,3	8,9	12,7	25,4	19,3	38,6	--	1,5
08B1.64	90°	Ciega	--	--	24,3	8,9	--	--	19,5	39	--	1,5
08B1.66	90°	Ciega	--	--	19,6	10,3	--	--	19,8	39,6	--	1,5
08B1.67	90°	1	4,25	--	24	7,5	14,3	28,6	19,3	38,6	--	1,5
08B1.68	90°	1	4,3	--	10,2	8,5	14	28	19,1	38,2	--	1,5
08B1.69	Recta	1	4,3	--	10,2	--	--	--	--	--	14	1,5
08B1.70	90°	1	5,2	--	17,5	8	13,7	27,4	19,9	39,8	--	1,5
08B1.71	90°	Ciega	--	--	20	10	--	--	16,3	32,6	--	1,5
08B1.73	90°	Ciega	--	--	19,6	8,9	--	--	21	42	--	1,5
08B1.75	90°	1	4,3	--	20	8,9	12,9	25,8	18,9	37,8	--	1,5
08B1.92	Recta	1	5,5	--	10,2	--	--	--	--	--	13,3	1,5
08B1.43	PINCHO		--	--	5,5	--	--	--	--	--	--	1,5
08B1.43AFIL	PINCHO AFILADA		--	--	5,5	--	--	--	--	--	--	1,5
08B1.48	PINCHO ANCHA		--	--	5	--	--	--	--	--	--	1,5
08B1.63	PROTUBERANCIA		--	--	20	8,9	12,7	25,4	19,4	38,8	--	1,5
08B1.45	ESCOTE 90°		--	--	--	--	--	--	--	--	--	1,5



CADENAS DE TRANSMISIÓN

Serie ISO Norma Europea DIN 8187

ACCESORIOS DIVERSOS 08B (12,7)

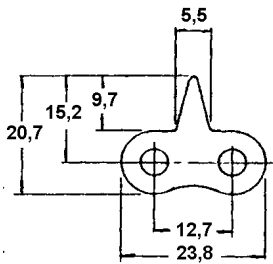

08B1.43

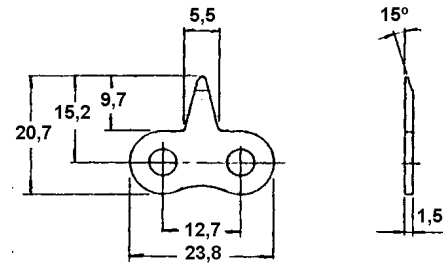

08B1.43 AFILADA

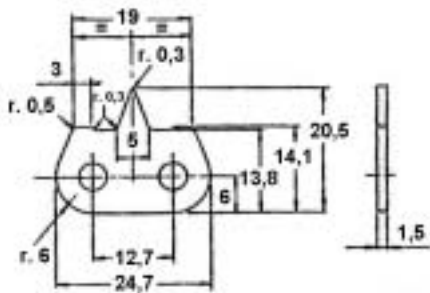

08B1.48

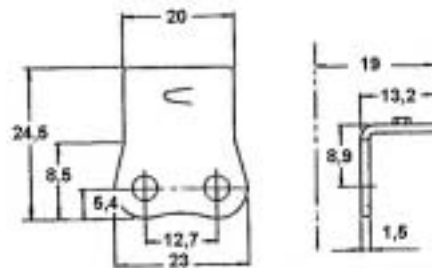

08B1.63

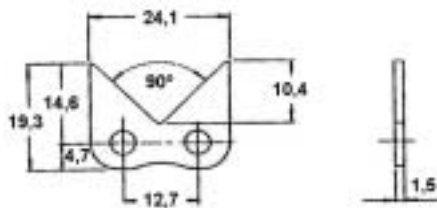

08B1.45

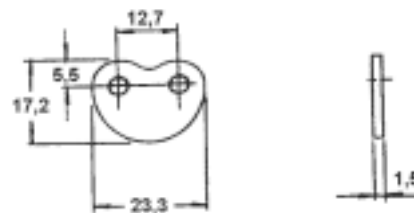

08B1.72

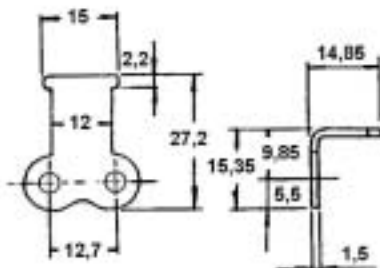

08B1.74

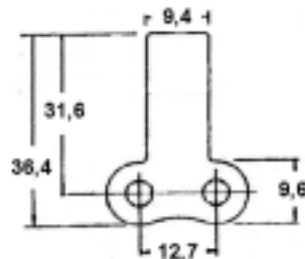

N° 1127-A

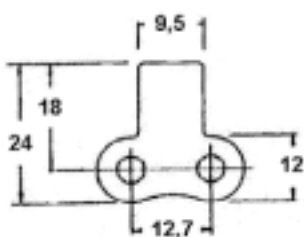

N° 79

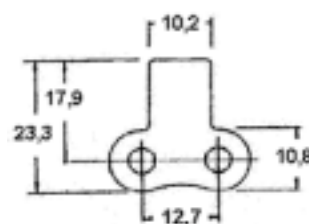

N° 287



CADENAS DE TRANSMISIÓN

Serie ISO Norma Europea DIN 8187
ACCESORIOS DIVERSOS 08B (12,7)

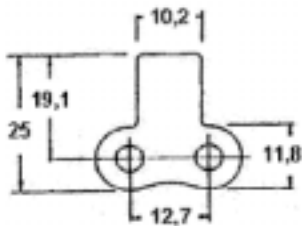

N° 283

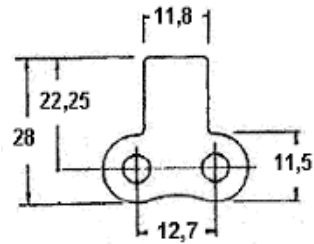

N° 217

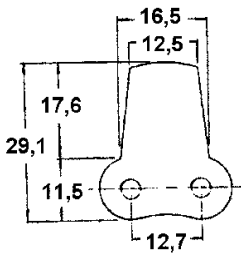

N° 364

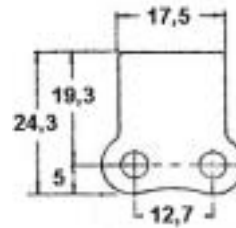

N° 371

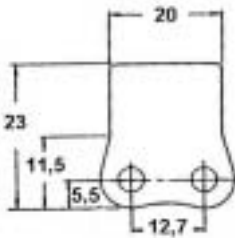

N° 370

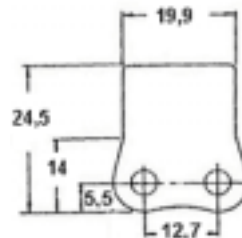

N° 569

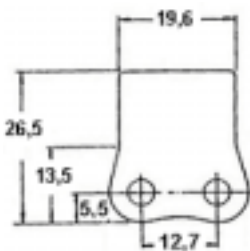

N° 372

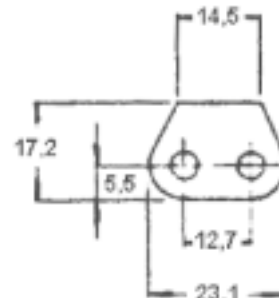

N° 1127-B

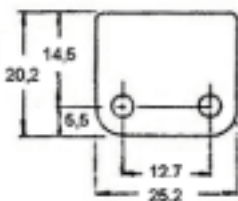

N° 132

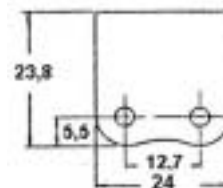

N° 373



CADENAS DE TRANSMISIÓN

Serie ISO Norma Europea DIN 8187
ACCESORIOS DIVERSOS 08B (12,7)

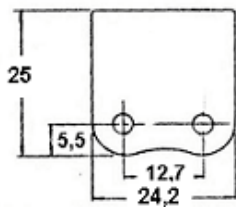

N° 227

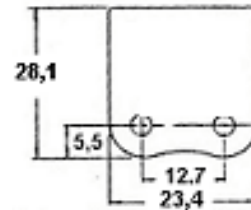

N° 121

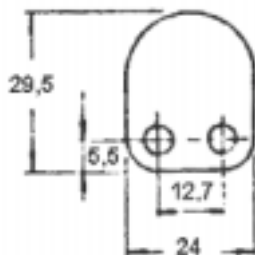

N° 127

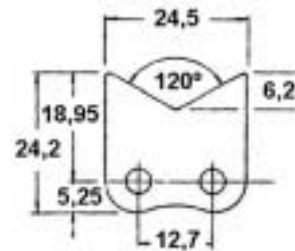

N° 684

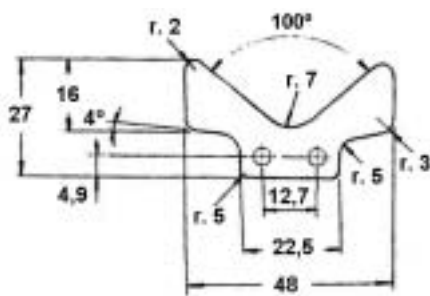

N° 7251

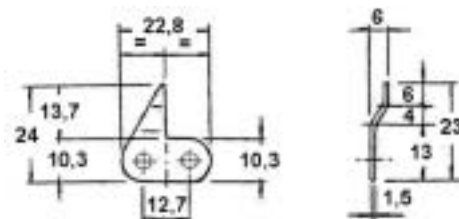

N° 372

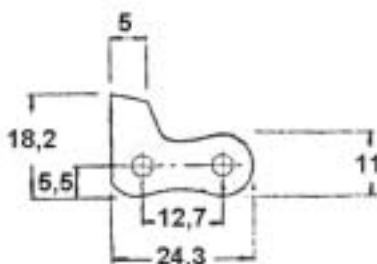

N° 135

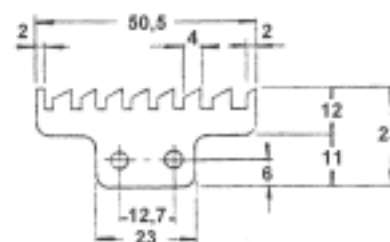

N° 570

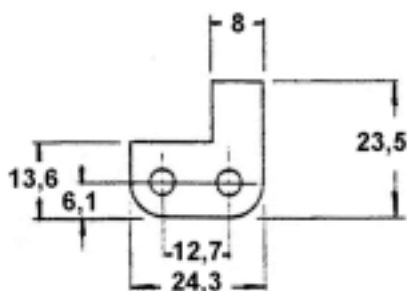

N° 9672

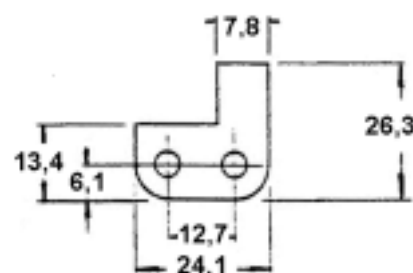

N° 12214



CADENAS DE TRANSMISIÓN

Serie ISO Norma Europea DIN 8187
ACCESORIOS DIVERSOS 08B (12,7)

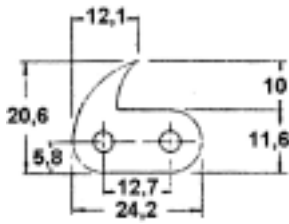

Nº 666

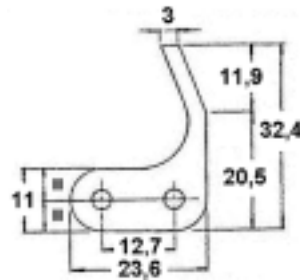

Nº 599

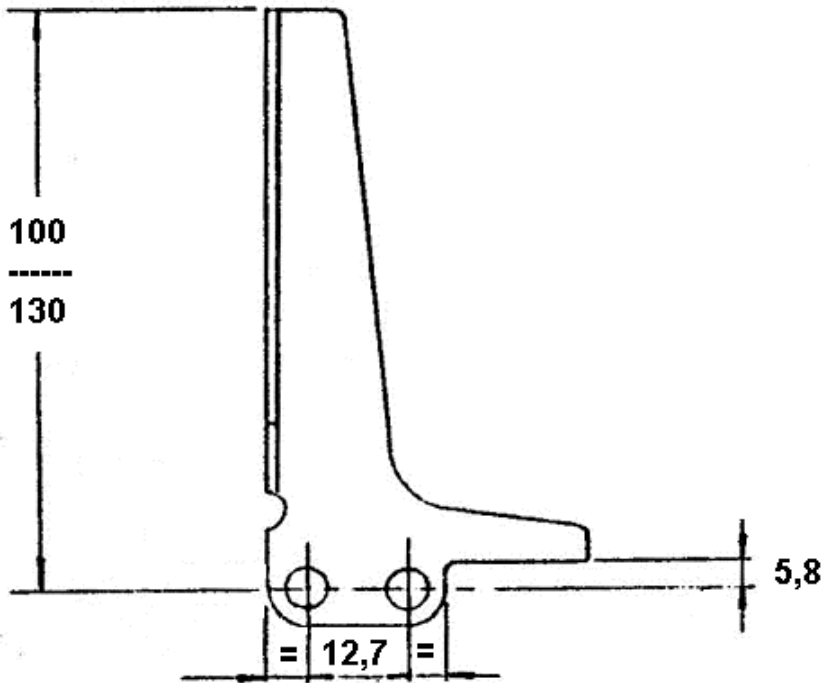

Nº 8063

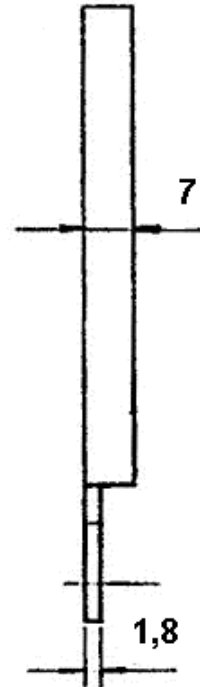



CADENAS DE TRANSMISIÓN

Serie ISO Norma Europea DIN 8187
ACCESORIOS NORMALIZADOS 10B (15,875)

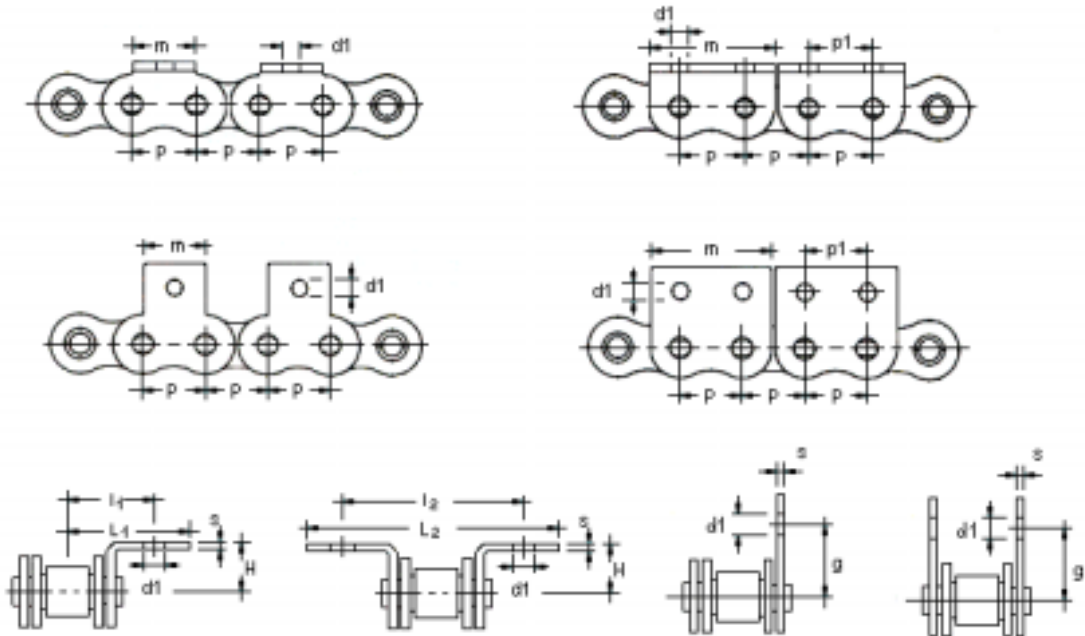

ACCESORIOS NORMALIZADOS DISPONIBLES PARA CADENA 10B (Paso 15,875 mm.)

Ref. Accesorio	Tipo	Nº Taladros	Ø d1	p1	m	H	l1	l2	L1	L2	g	s
10B1.41	Recta	1	5,3	--	12,6	--	--	--	--	--	15,88	1,6
10B1.42	Recta	2	5,3	15,87	30	--	--	--	--	--	15,88	1,6
10B1.58	Recta	Ciega	--	--	30	--	--	--	--	--	--	1,6
10B1.61	90°	1	5,3	--	12,6	10,3	15,87	31,75	24,2	48,4	--	1,6
10B1.62	90°	2	5,3	15,87	30	10,3	15,87	31,75	24,2	48,4	--	1,6
10B1.76	90°	1	6,5	--	24	10	17	34	24,6	49,2	--	1,6
10B1.43 AFIL	PINCHO AFILADA		--	--	6	--	--	--	--	--	--	1,6
10B1.43	PINCHO		--	--	6	--	--	--	--	--	--	1,6



CADENAS DE TRANSMISIÓN

Serie ISO Norma Europea DIN 8187
ACCESORIOS DIVERSOS 10B (15,875)

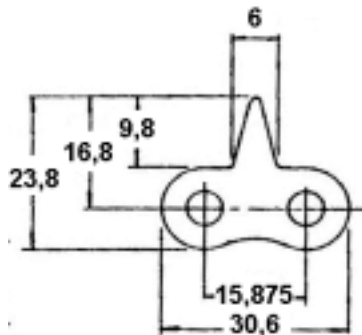

10B1.43

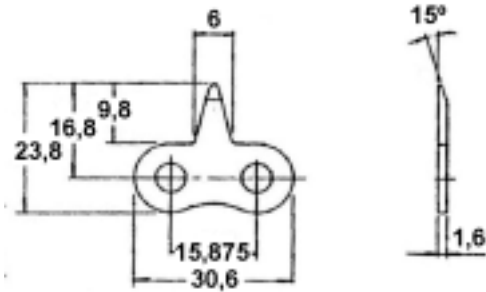

10B1.43 AFILADA

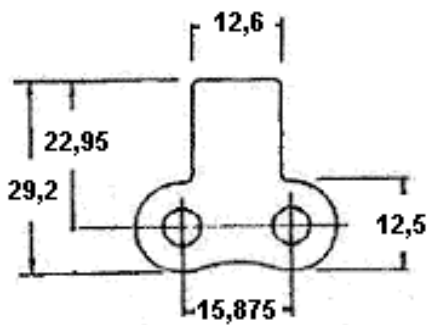

N° 203

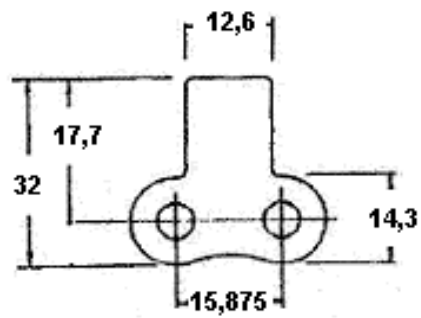

N° 065

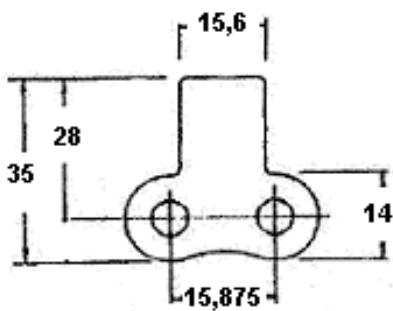

N° 168

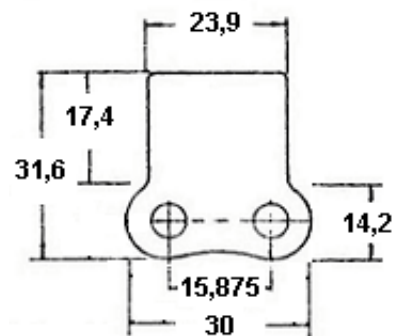

N° 162

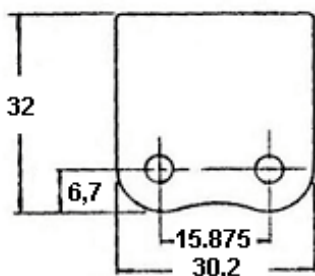

N° 390

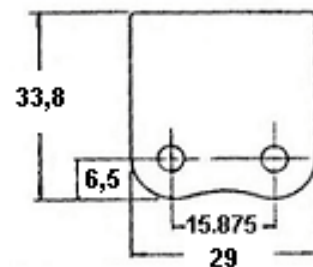

N° 197



CADENAS DE TRANSMISIÓN

Serie ISO Norma Europea DIN 8187
ACCESORIOS DIVERSOS 10B (15,875)

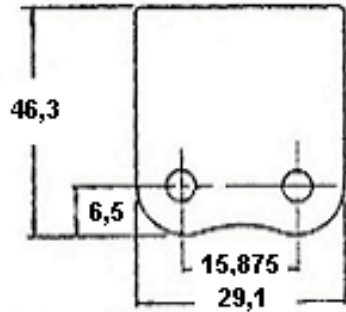

Nº 165

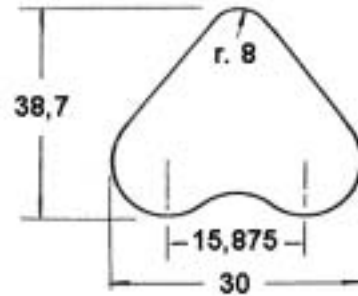

Nº 160

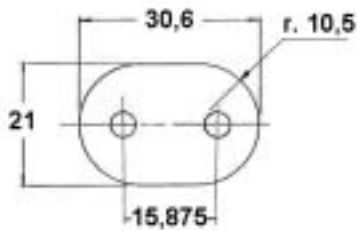

Nº 14273





CADENAS DE TRANSMISIÓN

Serie ISO Norma Europea DIN 8187

ACCESORIOS NORMALIZADOS 12B-1 (19,05)

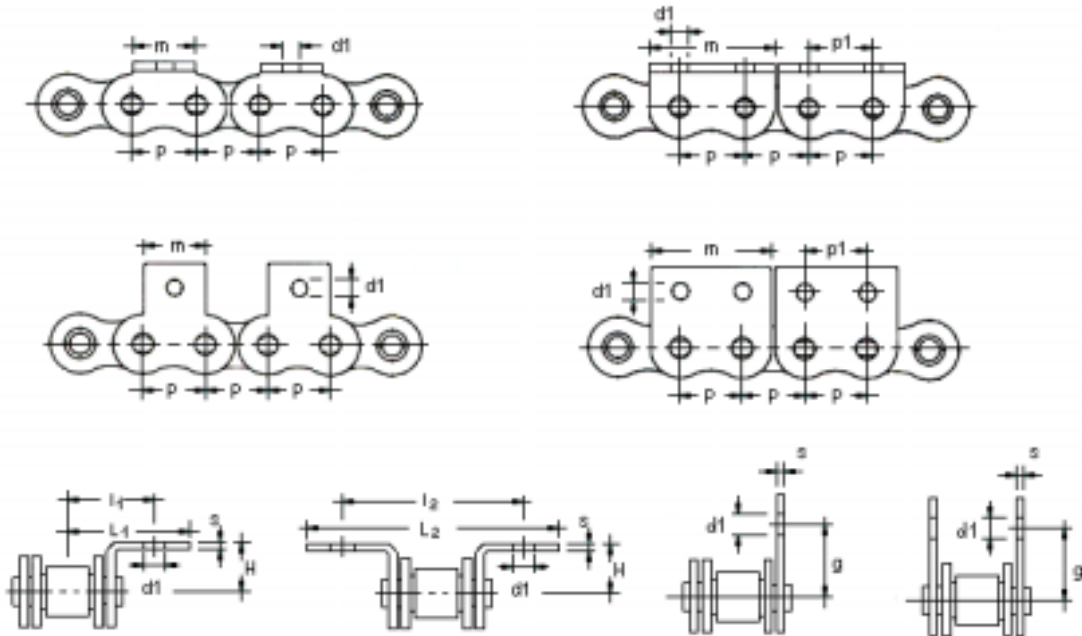

ACCESORIOS NORMALIZADOS DISPONIBLES PARA CADENA 12B (Paso 19,05 mm.)

Ref. Accesorio	Tipo	Nº Taladros	Ø d1	p1	m	H	l1	l2	L1	L2	g	s
12B1.41	Recta	1	6,4	--	15,3	--	--	--	--	--	18,25	1,8
12B1.42	Recta	2	6,4	19,05	34,7	--	--	--	--	--	18,25	1,8
12B1.61	90°	1	6,4	--	15,3	13,5	19,05	38,1	29,15	58,3	--	1,8
12B1.62	90°	2	6,4	19,05	34,7	13,5	19,05	38,1	29,1	58,2	--	1,8
12B1.90	90°	Ciega	--	--	37	12,2	--	--	28	56	--	1,8
12B1.241	Recta	1	9,1	--	19	--	--	--	--	--	18	1,8
12B1.243	90°	Ciega	--	--	19	12	--	--	27,85	55,7	--	1,8
12B1.43	PINCHO 45°		--	--	15,3	--	--	--	--	--	--	1,8
12B1.46	SIERRA		--	--	35	--	--	--	--	--	--	1,8



CADENAS DE TRANSMISIÓN

Serie ISO Norma Europea DIN 8187
ACCESORIOS DIVERSOS 12B (19,05)

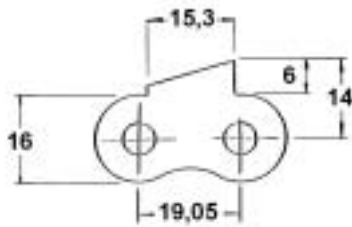

12B1.43

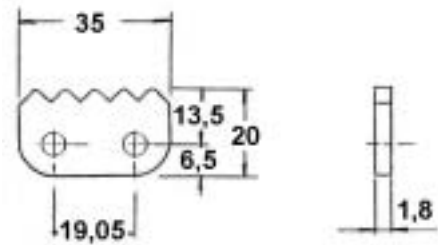

12B1.46

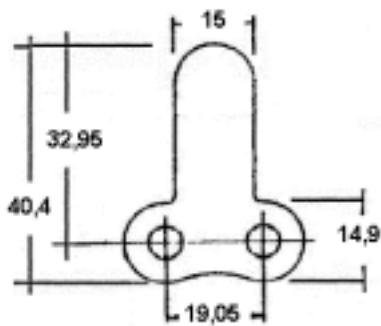

N° 190

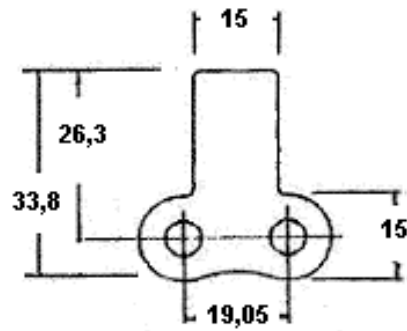

N° 202

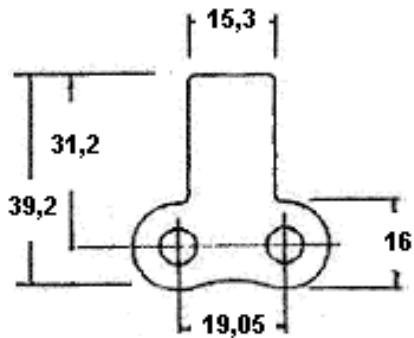

N° 370

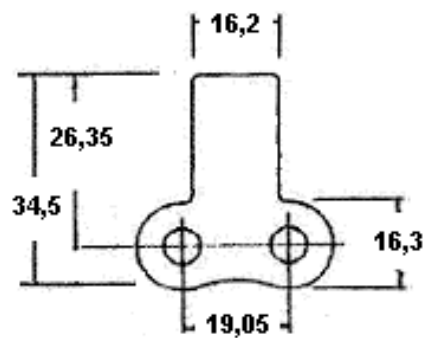

N° 260

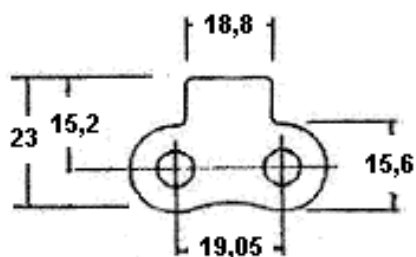

N° 194

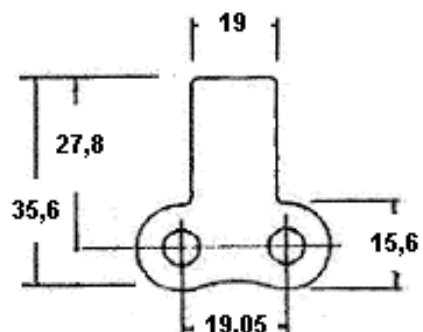

N° 195



CADENAS DE TRANSMISIÓN

Serie ISO Norma Europea DIN 8187
ACCESORIOS DIVERSOS 12B (19,05)

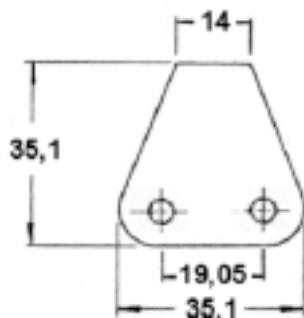

N° 192

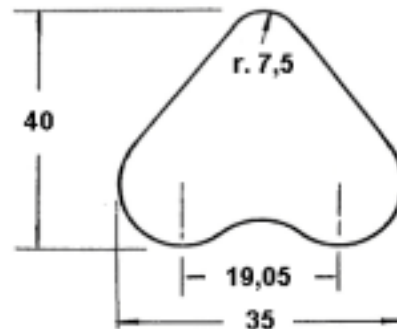

N° 191

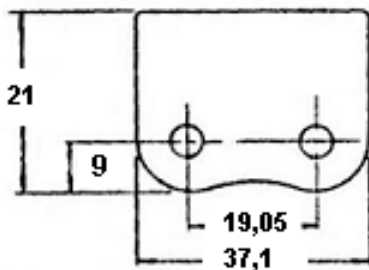

N° 194

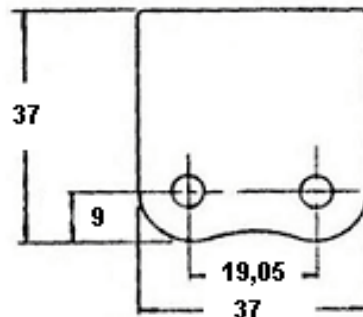

N° 89

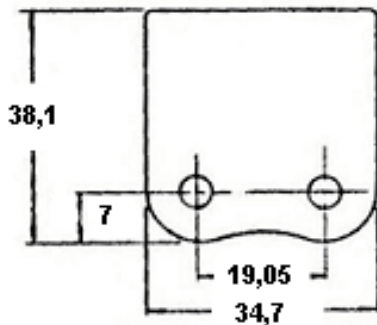

N° 196

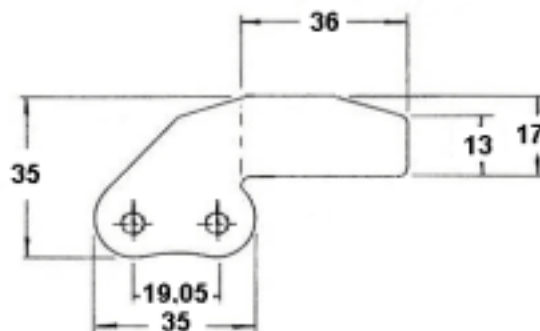

N° 167

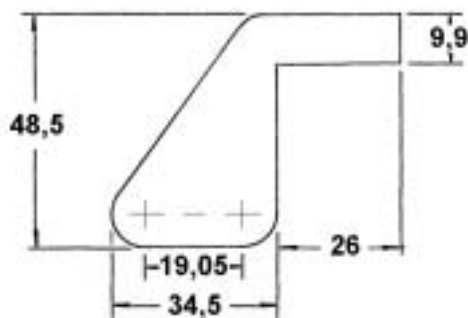

N° 161

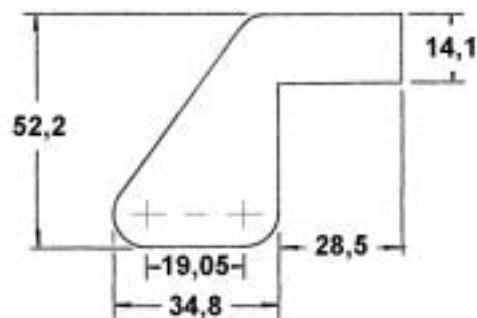

N° 162



CADENAS DE TRANSMISIÓN

Serie ISO Norma Europea DIN 8187
ACCESORIOS DIVERSOS 12B (19,05)

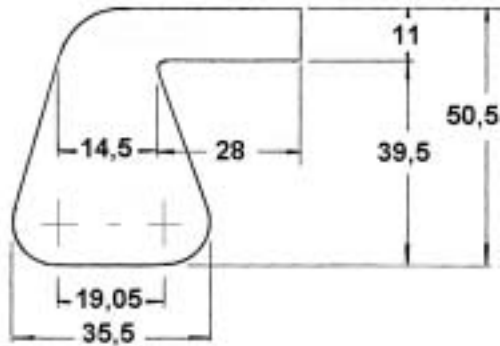

Nº 163





CADENAS DE TRANSMISIÓN

Serie ISO Norma Europea DIN 8187

ACCESORIOS NORMALIZADOS 16B-1 (25,4)

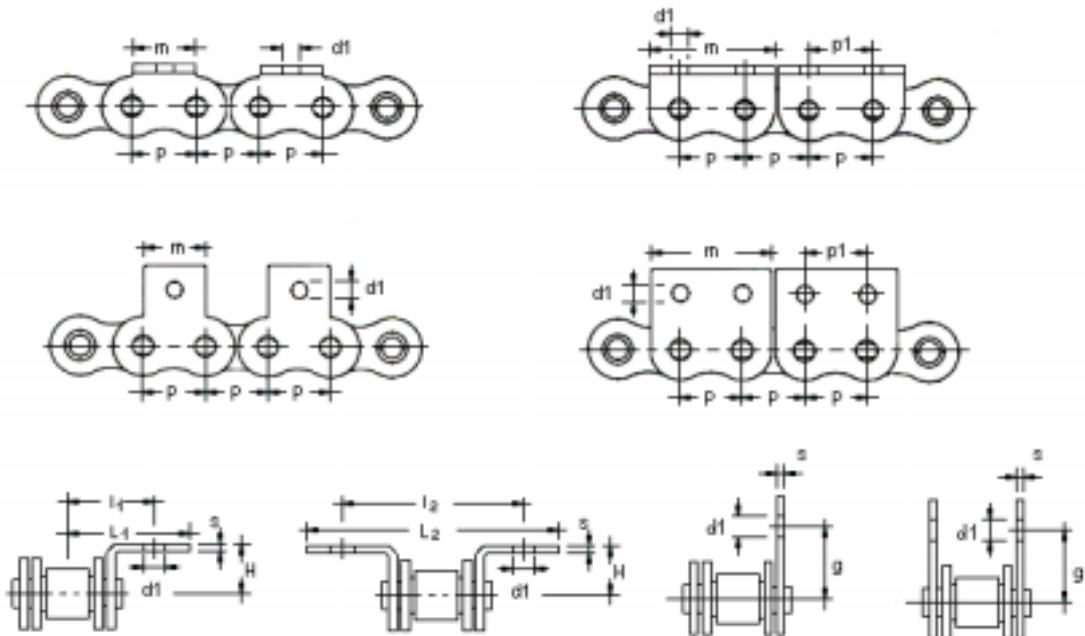

ACCESORIOS NORMALIZADOS DISPONIBLES PARA CADENA 16B (Paso 25,4 mm.)

Ref. Accesorio	Tipo	Nº Taladros	Ø d1	p1	m	H	l1	l2	L1	L2	g	s
16B1.41	Recta	1	8,4	--	20	--	--	--	--	--	24,6	3
16B1.42	Recta	2	8,4	25,4	46,4	--	--	--	--	--	24,6	3
16B1.61	90°	1	8,4	--	20	15,9	25,4	50,8	38,5	77	--	3
16B1.62	90°	2	8,4	25,4	46,4	15,9	25,4	50,8	38,7	77,4	--	3
16B1.331	90°	2	9	25,4	46,8	18	28,95	57,9	41,75	83,5	--	3



CADENAS DE TRANSMISIÓN

Serie ISO Norma Europea DIN 8187
ACCESORIOS DIVERSOS 16B-1 (25,4)

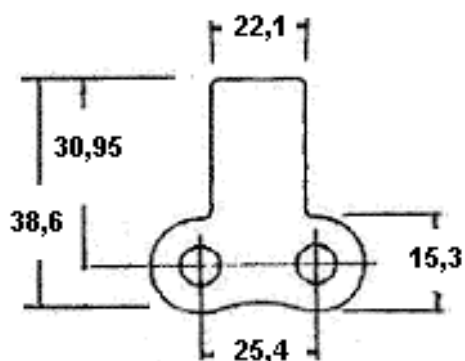

N° 3255

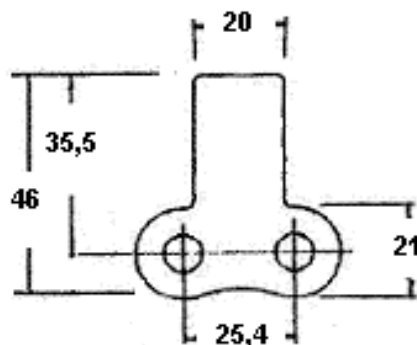

N° 8579

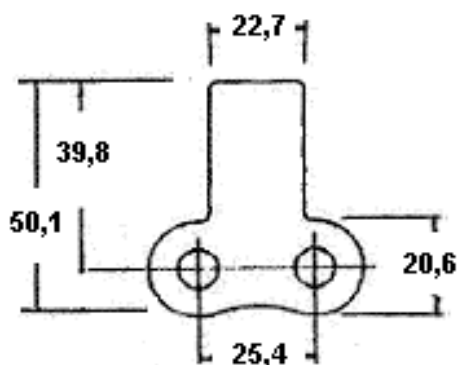

N° 8582

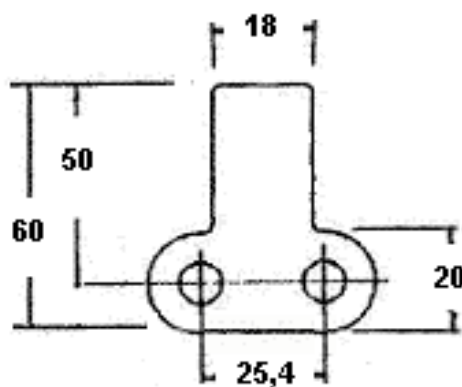

N° 7404

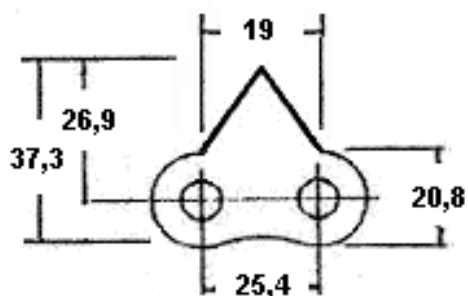

N° 361

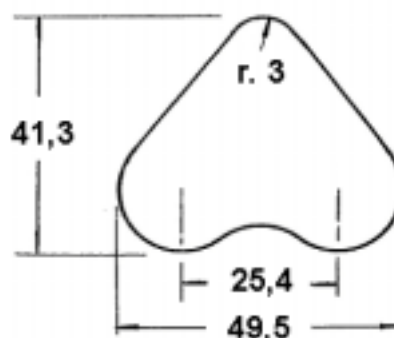

N° 8201



CADENAS DE TRANSMISIÓN

Serie ISO Norma Europea DIN 8187
ACCESORIOS DIVERSOS 16B-1 (25,4)

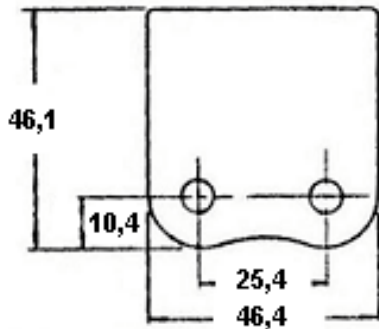

N° 8581

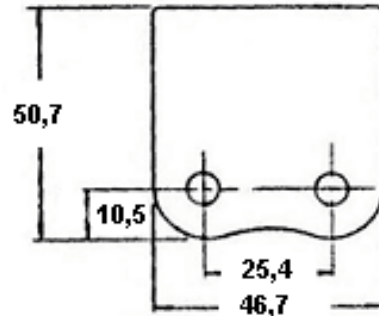

N° 8580

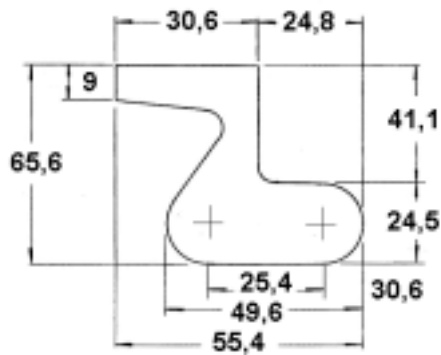

N° 435

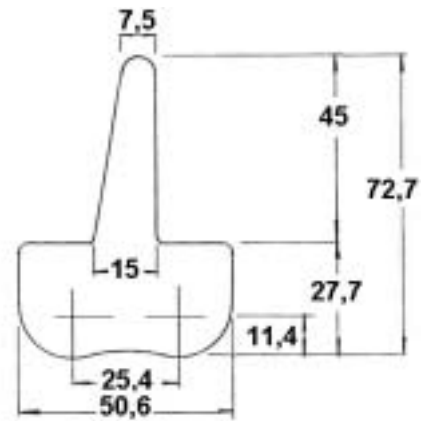

N° 656





CADENAS DE TRANSMISIÓN

Serie ISO Norma Europea DIN 8187

ACCESORIOS NORMALIZADOS 20B-1 (31,75)

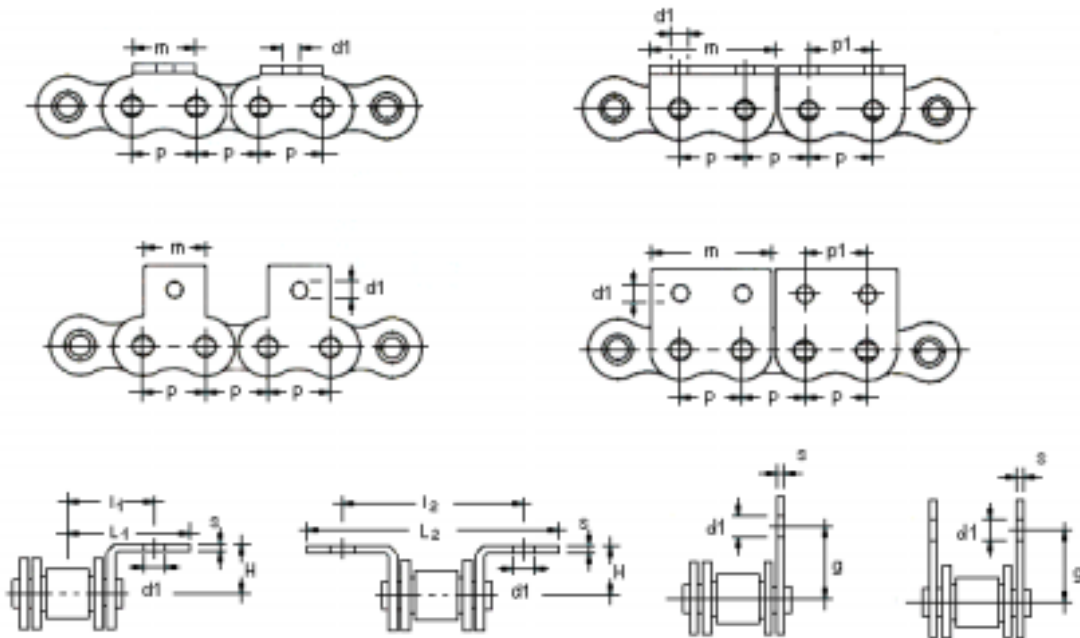

ACCESORIOS NORMALIZADOS DISPONIBLES PARA CADENA 20B (Paso 31,75 mm.)

Ref. Accesorio	Tipo	Nº Taladros	Ø d1	p1	m	H	l1	l2	L1	L2	g	s
20B1.41	Recta	1	8,4	--	25,5	--	--	--	--	--	31,75	3,5
20B1.42	Recta	2	8,4	31,75	57	--	--	--	--	--	31,75	3,5
20B1.61	90°	1	8,4	--	25,5	19,84	31,75	63,5	45,8	91,6	--	3,5
20B1.62	90°	2	8,4	31,75	57	19,84	31,75	63,5	45,8	91,6	--	3,5
20B1.411	90°	2	6,5	16	56	21	42,25	84,5	52,15	104,3	--	4



CADENAS DE TRANSMISIÓN

Serie ISO Norma Europea DIN 8187
ACCESORIOS DIVERSOS 20B-1 (31,75)

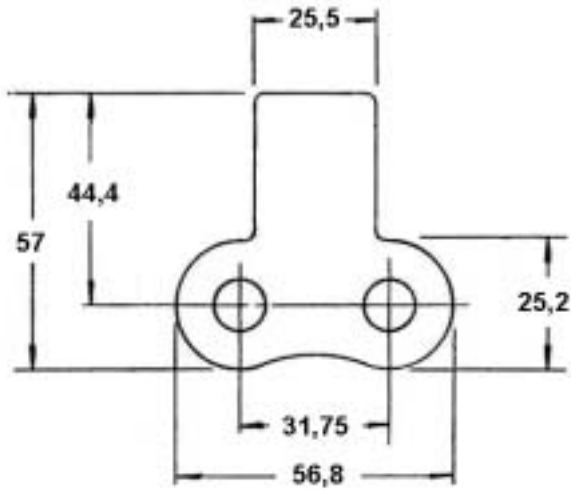

N° 357

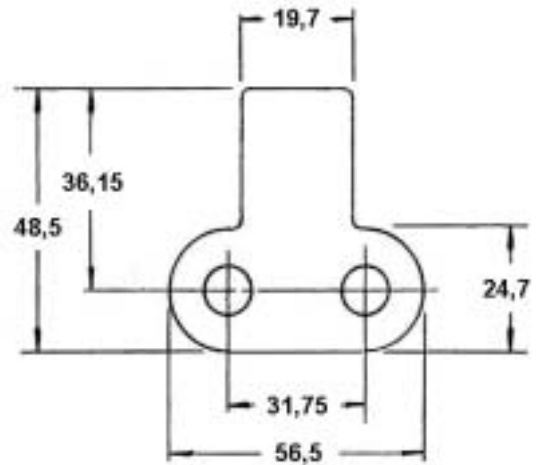

N° 365

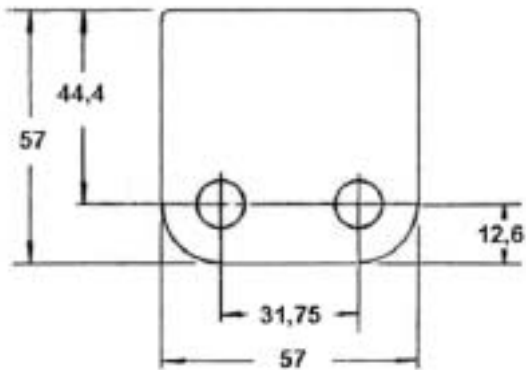

N° 4357

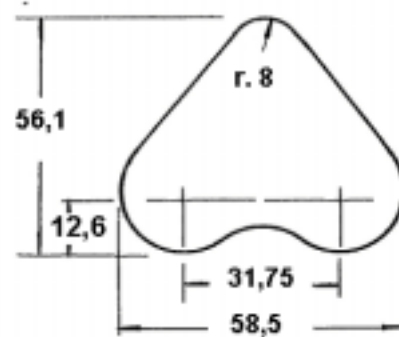

N° 3201



CADENAS DE TRANSMISIÓN

Serie ISO Norma Europea DIN 8187

ACCESORIOS NORMALIZADOS 24B-1 (38,1)

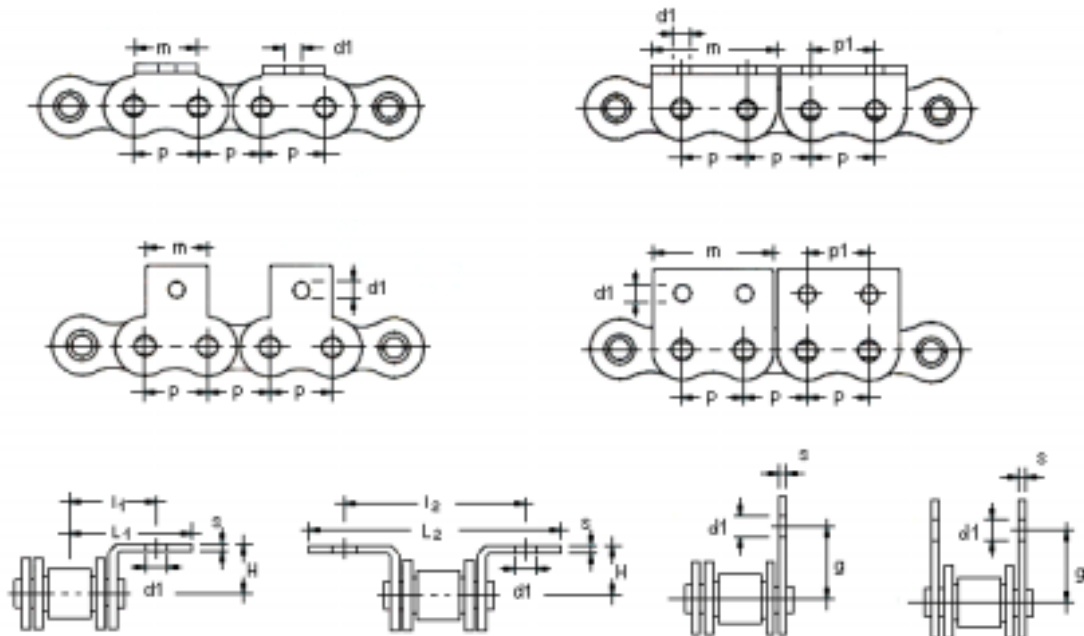

ACCESORIOS NORMALIZADOS DISPONIBLES PARA CADENA 24B (Paso 38,1 mm.)

Ref. Accesorio	Tipo	Nº Taladros	Ø d1	p1	m	H	l1	l2	L1	L2	g	s
24B1.41	Recta	1	10,5	--	30,1	--	--	--	--	--	36,51	5
24B1.42	Recta	2	10,5	38,1	70	--	--	--	--	--	36,51	5
24B1.61	90°	1	10,5	--	30,1	26,7	38,1	76,2	53	106	--	5
24B1.62	90°	2	10,5	38,1	70	26,7	38,1	76,2	52,8	105,6	--	5



CADENAS DE TRANSMISIÓN
Serie ISO Norma Europea DIN 8187
ACCESORIOS DIVERSOS 24B-1 (38,1)

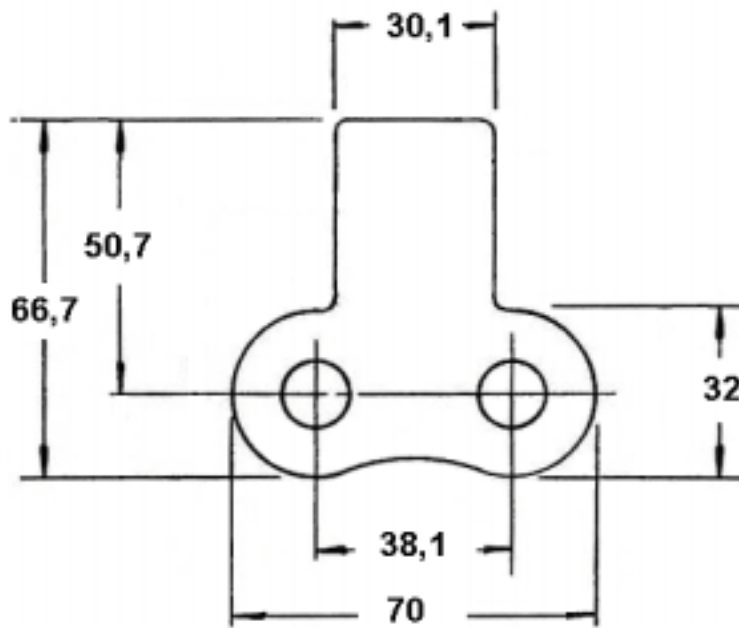

N° 458

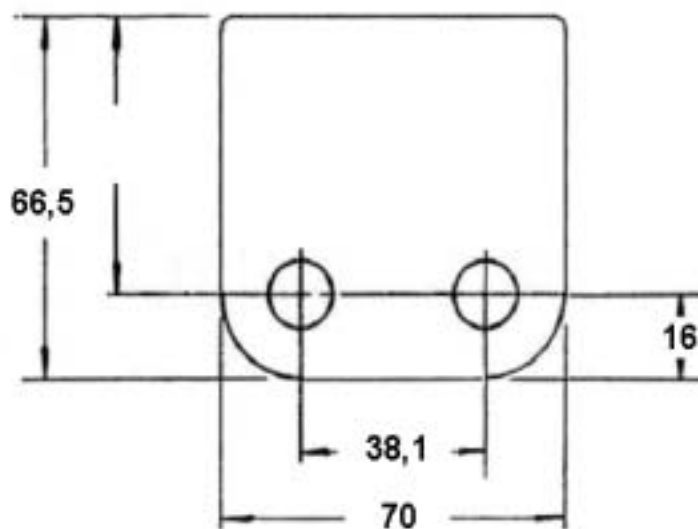

N° 381